



CANTRELL

WORLDWIDE INC.

2154 CHENAULT DRIVE • BUILDING A • CARROLLTON • TEXAS • 75006

PHONE: 972-302-2557 • FAX: 214-279-0855

WWW.CANTRELLWORLDWIDE.COM

NEW...

AIR DENSITY SEPARATOR

Simple to install and operate.

Counterflow air design allows complete separation of various product densities.

Single ' Constant' CFM requirement
Variable speed roll feeder allows constant uniform feed rate.

Air control damper can be set at the fan for ease of operation.



Slope of incline angles and generous product area makes the design almost impossible to choke.

Various sizes to fit your volume needs

Large oversize viewing windows make separation adjustments easy.

SPECIFICATIONS: DENSITY SEPARATOR

FRONT

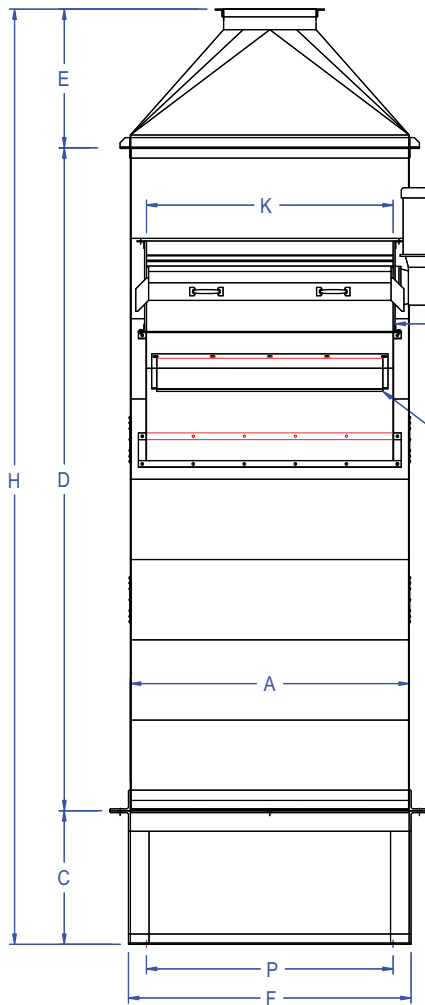

ELEVATION

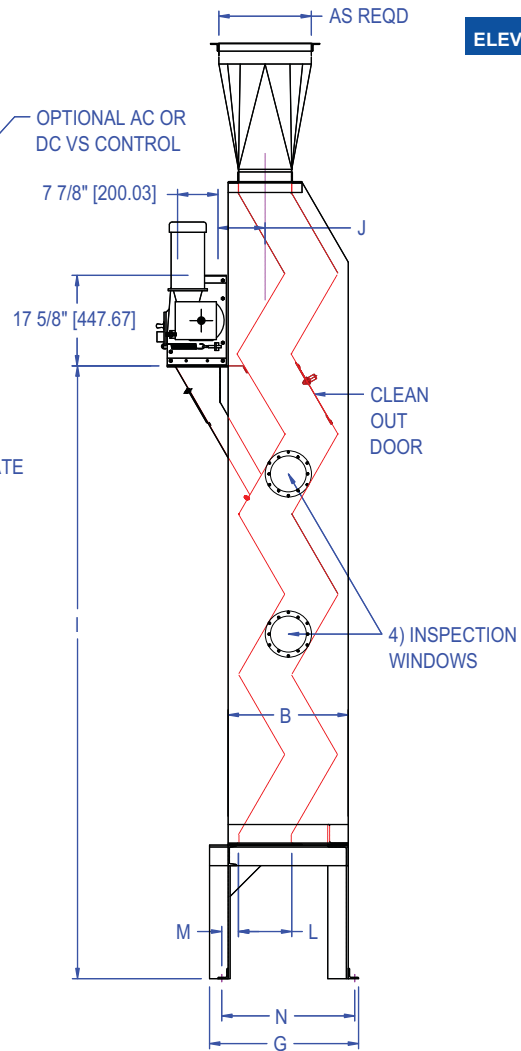

STD SIZES	AREA	HP	A	B	C	D	E	F	G	H
8 X 30	1.67FT ² [1.155M] ²	.75	30" [762]	23 ³ / ₈ " [593.7]	26" [660]	117 ³ / ₈ " [2981.3]	27" [685.8]	31" [787.4]	29" [736.6]	170 ³ / ₈ " [4327.5]
8 X 48	2.67FT ² [2.48M] ²	.75	48" [1220]	23 ³ / ₈ " [593.7]	26" [660]	117 ³ / ₈ " [2981.3]	27" [685.8]	49" [1244.6]	29" [736.6]	170 ³ / ₈ " [4327.5]
9 X 54	3.38FT ² [3.14M] ²	1	54" [1372]	23 ³ / ₈ " [593.7]	26" [660]	129" [3276.6]	27" [685.8]	55" [1397]	29" [736.6]	182" [4622.8]
10 X 60	4.17FT ² [3.87M] ²	1	60" [1524]	25 ¹ / ₂ " [647.7]	36" [915]	143" [3632.2]	36" [914.4]	61" [1549.4]	34" [863.6]	215" [5461]
12 X 60	5.0 FT ² [4.64M] ²	1	60" [1524]	29 ⁷ / ₈ " [758.8]	36" [915]	170 ¹ / ₄ " [4324.3]	36" [914.4]	61" [1549.4]	34" [863.6]	242 ¹ / ₄ " [6153.1]

STD SIZES	I	J	K	L	M	N	P	SHIPPING VOLUME	SHIPPING WEIGHT
8 X 30	113 ⁵ / ₈ " [2873.3]	9 ³ / ₁₆ " [233.3]	24" [609.6]	9 ¹ / ₄ " [234.9]	3 ³ / ₁₆ " [80.9]	25 ⁷ / ₈ " [657.2]	24" [609.6]	88.6FT ³ [2.5M] ³	725 LBS [329Kg]
8 X 48	113 ⁵ / ₈ " [2873.3]	9 ³ / ₁₆ " [233.3]	36" [914.4]	9 ¹ / ₄ " [234.9]	3 ³ / ₁₆ " [80.9]	25 ⁷ / ₈ " [657.2]	42" [1066.8]	140FT ³ [3.9M] ³	1060 LBS [481Kg]
9 X 54	119 ¹ / ₄ " [3028.9]	9 ³ / ₁₆ " [233.3]	48" [1219.2]	10 ³ / ₈ " [263.5]	3 ¹ / ₄ " [82.5]	25 ⁷ / ₈ " [657.2]	48" [1219.2]	168FT ³ [4.7M] ³	1203 LBS [545Kg]
10 X 60	130" [3302]	10 ⁵ / ₁₆ " [261.9]	48" [1219.2]	11 ⁹ / ₁₆ " [293.6]	9 ⁷ / ₁₆ " [239.7]	32 ⁷ / ₈ " [835.0]	54" [1371.6]	258FT ³ [7.3M] ³	1350 LBS [612Kg]
12 X 60	151" [3835.4]	11 ⁵ / ₈ " [295.2]	48" [1219.2]	13 ⁷ / ₈ " [352.4]	4 ³ / ₄ " [120.6]	32 ⁷ / ₈ " [835.0]	54" [1371.6]	290FT ³ [8.2M] ³	1500 LBS [680Kg]



CANTRELL
WORLDWIDE INC.

2154 CHENAULT DRIVE ● BUILDING A ● CARROLLTON ● TEXAS ● 75006
PHONE: 972-302-2557 ● FAX: 214-279-0855

WWW.CANTRELLWORLDWIDE.COM